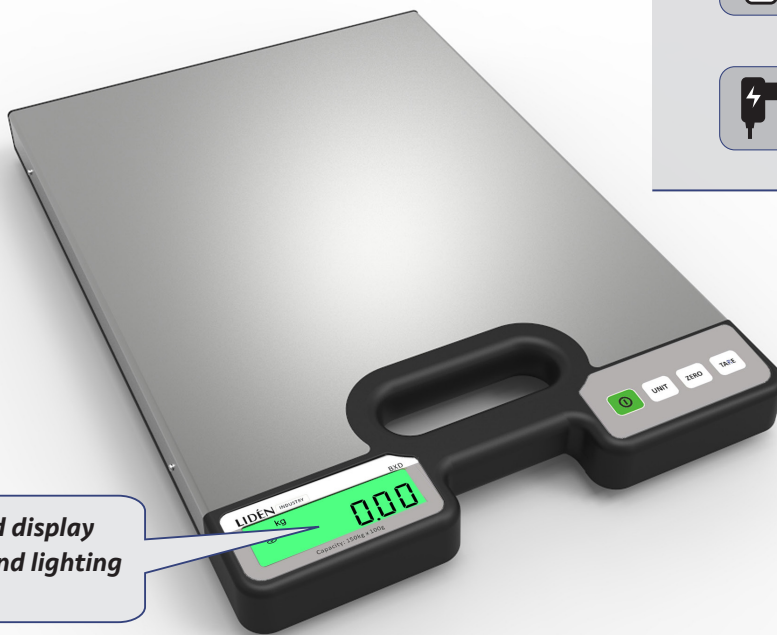

Table scale BXD

Affordable portable table and floor scale

Affordable table and floor scale for general weighing in dry environments. Rechargeable battery, stainless steel scale platform and integrated carrying handle.



Rechargeable battery



Adapter

Benefits

- ✓ Stainless steel platform
- ✓ Automatic background lighting
- ✓ Automatic shutdown
- ✓ 16 mm high numbers, easy-to-read LCD display with background lighting
- ✓ AC/DC adapter and rechargeable battery
- ✓ Automatic "HOLD" function
- ✓ Capacity: 100kg x 50g

| Technical specifications | BXD |
|-----------------------------|--------------------------|
| Capacity (kg) | 100 |
| Readability (g) | 50 |
| Accuracy (g) | +/-3-5d |
| Weighing platform size (mm) | 450 x 320 |
| Size, product (LxWxH mm) | 450 x 320 x 45 |
| Net weight (kg) | 2,5 |
| Display | LCD, 16mm with backlight |

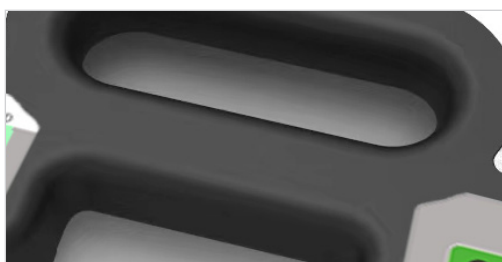

Integrated handle for easy movement



External adjustment



Unit selection, kg, lb



CE-marked



Warranty 1 year



LCD display with backlight



Load cell



Adapter



Rechargeable battery



Plastic (ABS)



Stainless steel platform